

# Section III Views & Parts List

## 3-1 Exploded View

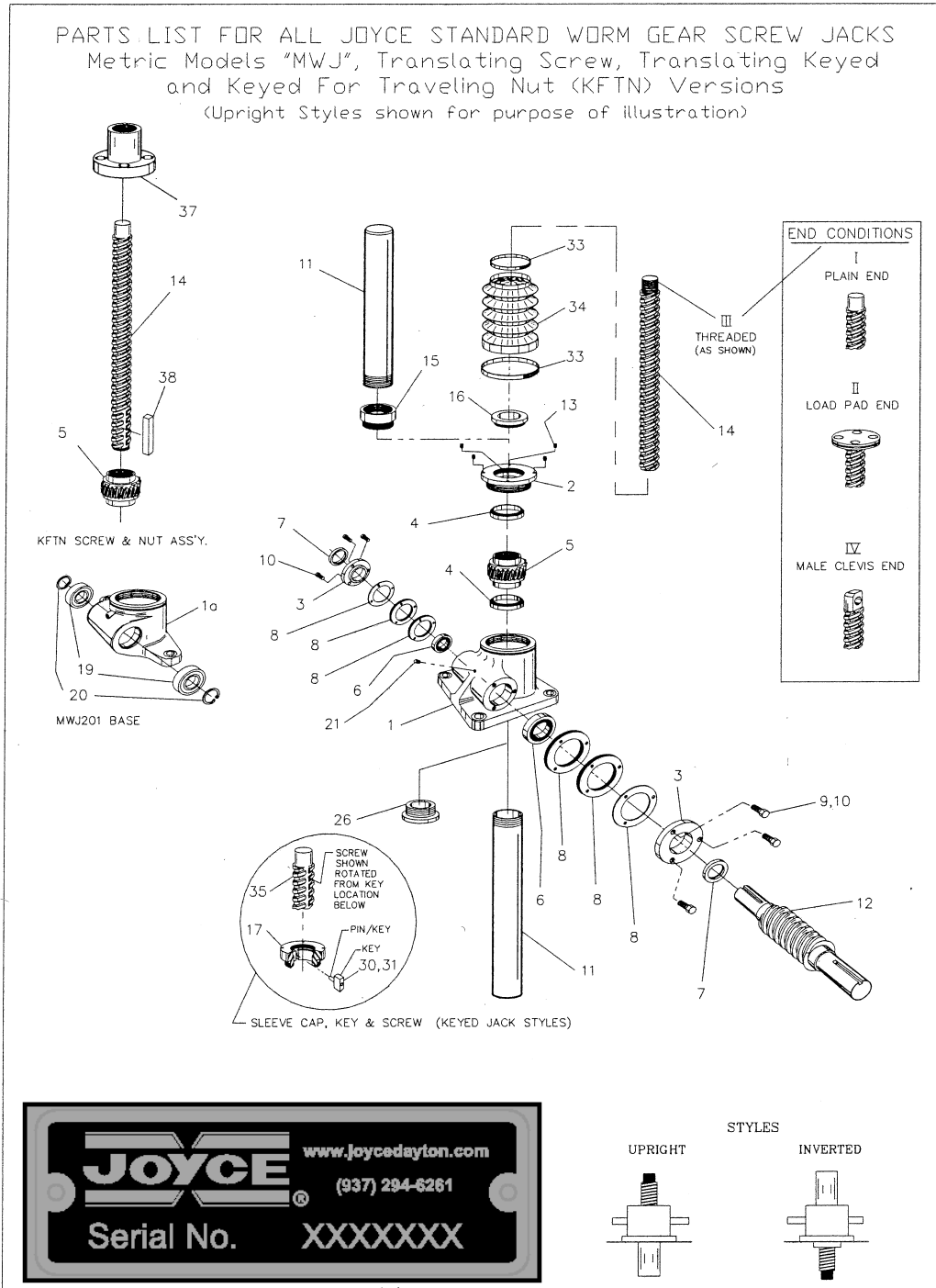

### 3-2 Parts List – Translating and KFTN jacks

**Table 3-1 Metric Parts list**

Item	Translating	Item	KFTN- Keyed For Traveling Nut
1	Sleeve	1	Sleeve
1a	Sleeve (MWJ51 & MWJ201 jack)	1a	Sleeve (MWJ51 & MWJ201 jack)
2	Sleeve Cap	2	Sleeve Cap
3	Bearing Cap (2)	3	Bearing Cap (2)
4	Thrust Bearing	4	Thrust Bearing
5	Wormgear	5	Wormgear
6	Worm Shaft Bearing (2)	6	Worm Shaft Bearing (2)
7	Worm Shaft Seal (2)	7	Worm Shaft Seal (2)
8	Shims	8	Shims
9	Bearing Cap Lockwasher (6-8)	9	Bearing Cap Lockwasher (6-8)
10	Bearing Cap Screw (6-8)	10	Bearing Cap Screw (6-8)
11	Protection Tube	11	-----
12	Worm (Input Shaft)	12	Worm (Input Shaft)
13	Set Screw – sleeve cap (4)	13	Set Screw - sleeve cap (4)
14	Lifting Screw	14	Lifting Screw
15	Protection Tube Adapter (Inverted only)	15	-----
16	-----	16	Seal
17	Keyed Sleeve Cap	17	-----
18	O-ring seal**	18	O-ring seal**
19	Bushing (MWJ51 & MWJ201 jacks only) (2)	19	Bushing (MWJ51 & MWJ201 jacks only) (2)
20	Retaining Ring (MWJ51 & MWJ201 jacks only) (2)	20	Retaining Ring (MWJ51 & MWJ201 jacks only) (2)
21	Grease Fitting	21	Grease Fitting
22	Drive Screw (2)	22	Drive Screw (2)
23	Name Plate	23	Name Plate
24	Top Bushing**	24	Top Bushing**
25	-----	25	-----
26	Bushing (inverted only)	26	Bushing (inverted only)
27	Base Plate**	27	-----
28	Sleeve Bolts (16)	28	Sleeve Bolts (16)
29	Base Shim	29	Base Shim
30	Key – keyed jacks	30	-----
31	Key screw – keyed jacks	31	-----
32	Alignment Pin	32	-----
33	Boot Clamp	33	Boot Clamp
34	Bellows Boot	34	Bellows Boot
35	Keyed Screw	35	-----
36	Sleeve cap screws (8)**	36	-----
37	-----	37	Traveling Nut
38	-----	38	Key - KFTN

\* Keyed Jack styles only