

1" -4 SINGLE LEAD ACME

This 1" - 4 single lead acme machine screw is available in both alloy steel and stainless steel with a corresponding aluminum bronze nut. Choose from right-hand or left-hand threads.

MACHINE SCREW SPECIFICATIONS	RH	LH
ALLOY STEEL SCREW NO.	AS 100 R 025 A	AS 100 L 025 A
STAINLESS STEEL SCREW NO.	AS 100 R 025 S	A S100 L 025 S
THREAD FORM		ACME
SCREW DIAMETER - TURNS / INCH		1-4
PITCH / LEAD		0.250 IN.
ROOT DIAMETER		0.699 IN.
SCREW WEIGHT (LBS./FOOT)		2.2
TORQUE TO RAISE 1 POUND		0.097 IN.-LB.
MAXIMUM SCREW LENGTH		12 FEET

Nut and Flange Specifications

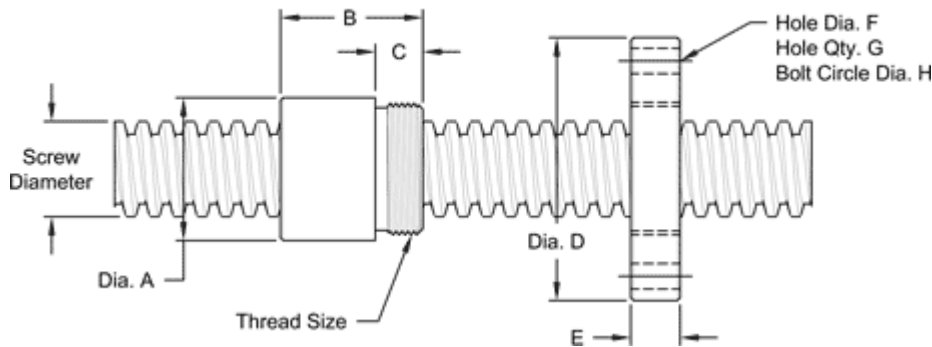

NUT SPECIFICATIONS	RH	LH
NUT PART NO.	AN 100 R 025 B	AN 100 L 025 B
NUT WITH FLANGE PART NO.	AF 100 R 025	AF 100 L 025
DYNAMIC LOAD CAPACITY (LBS.)		5,000
STATIC LOAD CAPACITY (LBS.)		16,000
EFFICIENCY		41.9%
MATERIAL		BRONZE
NOMINAL DIAMETER "A"		1.50 IN.
NUT LENGTH "B"		1.50 IN.
THREAD LENGTH "C"		0.50 IN.
THREAD SIZE		1.375-16 UN
FLANGE PART NUMBER	FL-1375	
FLANGE DIAMETER "D"		2.75 IN.
FLANGE THICKNESS "E"		0.52 IN.
FLANGE HOLE DIAMETER "F"		0.266 IN.
NUMBER OF HOLES IN FLANGE "G"		4
FLANGE BOLT CIRCLE "H"		2.260 IN.
FLANGE MATERIAL		BLACK OXIDE COATED STEEL