

This 7/8 – 2 Double lead acme machine screw is available in both alloy steel and stainless steel with a corresponding aluminum bronze nut. Choose from right-hand or left-hand threads.

MACHINE SCREW SPECIFICATIONS	RH	LH
ALLOY STEEL SCREW PART NO.	AS 088 R 050 A	AS 088 L 050 A
STAINLESS STEEL SCREW PART NO.	AS 088 R 050 S	AS 088 L 050 S
THREAD FORM	ACME	
SCREW DIAMETER (TURNS / INCH)	7/8" - 2	
PITCH / LEAD	0.250 IN./0.500 IN.	
ROOT DIAMETER	0.574 IN.	
SCREW WEIGHT (LBS. / FOOT)	1.7	
TORQUE TO RAISE 1 POUND	0.132 IN.- LB.	
MAXIMUM SCREW LENGTH	12 FEET	

Nut and Flange Specifications

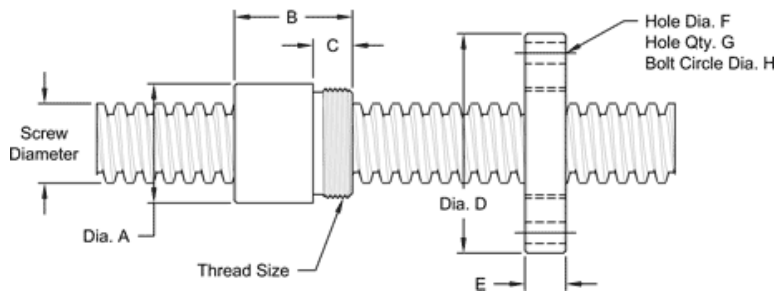

NUT SPECIFICATIONS	RH	LH
NUT PART NO.	AN 088 R 050 B	AN 088 L 050 B
NUT WITH FLANGE PART NO.	AF 088 R 050	AF 088 L 050
DYNAMIC LOAD CAPACITY (LBS.)	3,828	
STATIC LOAD CAPACITY (LBS.)	12,250	
EFFICIENCY	61.5%	
MATERIAL	BRONZE	
NOMINAL DIAMETER "A"	1.50 IN.	
NUT LENGTH "B"	1.50 IN.	
THREAD LENGTH "C"	0.50 IN.	
THREAD SIZE	1.375-16 UN	
FLANGE PART NO.	FL-1375	
FLANGE DIAMETER "D"	2.75 IN.	
FLANGE THICKNESS "E"	0.52 IN.	
FLANGE HOLE DIAMETER "F"	0.266 IN.	
NUMBER OF HOLES IN FLANGE "G"	4	
FLANGE BOLT CIRCLE "H"	2.260 IN.	
FLANGE MATERIAL	BLACK OXIDE COATED STEEL	