

## 6"-1 1/3 SINGLE LEAD ACME

This 6"-1 1/3 single lead acme machine screw is available in both alloy steel and stainless steel with a corresponding aluminum bronze nut. This is available with right-hand or left-hand threads.

MACHINE SCREW SPECIFICATIONS	RH	LH
ALLOY STEEL SCREW PART NO.	AS 600 R 075 A	AS 600 L 075 A
STAINLESS STEEL SCREW PART NO.	AS 600 R 075 S	AS 600 L 075 S
THREAD FORM		ACME
SCREW DIAMETER - TURNS/INCH		6" - 1 1/3
PITCH/LEAD		0.750 IN.
ROOT DIAMETER		5.169 IN.
SCREW WEIGHT (LB/FT)		87
TORQUE TO RAISE 1 POUND		0.485 IN.-LB.
MAXIMUM SCREW LENGTH		20 FEET

### Nut and Flange Specifications

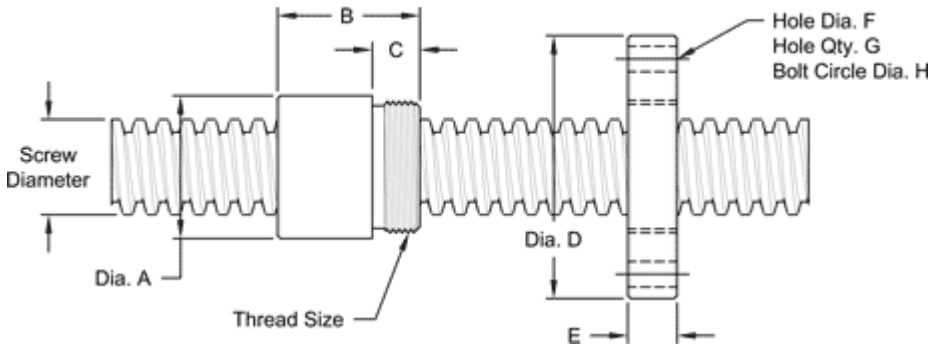

NUT SPECIFICATIONS	RH	LH
NUT PART NO.	AN 600 R 075 B	AN 600 L 075 B
NUT WITH FLANGE PART NO.	AF 600 R 075	AF 600 L 075
DYNAMIC LOAD CAPACITY (LBS)		150,000
STATIC LOAD CAPACITY (LBS)		470,000
EFFICIENCY		25.4%
MATERIAL		BRONZE
NOMINAL DIAMETER "A"		8.00 IN.
NUT LENGTH "B"		7.00 IN.
THREAD LENGTH "C"		2.000 IN.
THREAD SIZE		7.847-8 UN
<b>FLANGE PART NUMBER</b>	<b>FL-7847</b>	
FLANGE DIAMETER "D"		14.00 IN
FLANGE THICKNESS "E"		2.020 IN.
FLANGE HOLE DIAMETER "F"		1.125 IN.
NUMBER OF HOLES IN FLANGE "G"		6
FLANGE BOLT CIRCLE "H"		12.000 IN.
FLANGE MATERIAL		BLACK OXIDE COATED STEEL