

## 4 1/2" - 1 1/2 SINGLE LEAD ACME

This 4 1/2"-1 1/2 single lead acme machine screw is available in both alloy steel and stainless steel with a corresponding aluminum bronze nut. Choose right-hand or left-hand threads.

MACHINE SCREW SPECIFICATIONS	RH	LH
ALLOY STEEL SCREW PART NO.	AS 450 R 067 A	AS 450 L 067 A
STAINLESS STEEL SCREW PART NO.	AS 450 R 067 S	AS 450 L 067 S
THREAD FORM	ACME	
SCREW DIAMETER - TURNS/INCH	4 1/2" - 1 1/2	
PITCH/LEAD	0.067 IN.	
ROOT DIAMETER	3.757 IN.	
SCREW WEIGHT (LB/FT)	45.0	
TORQUE TO RAISE 1 POUND	0.378 IN.-LB.	
MAXIMUM SCREW LENGTH	20 FEET*	

\*12 feet for stainless steel stock

### Nut and Flange Specifications

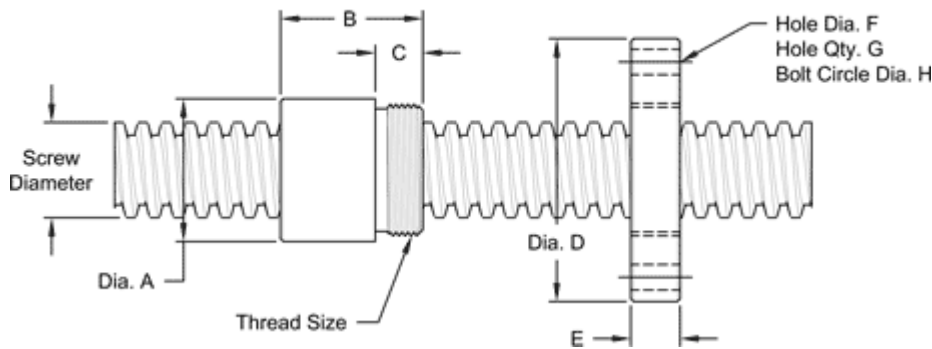

NUT SPECIFICATIONS	RH	LH
NUT PART NO.	AN 450 R 067 B	AN 450 L 067 B
NUT WITH FLANGE PART NO.	AF 450 R 067	AF 450 L 067
DYNAMIC LOAD CAPACITY (LBS)	100,000	
STATIC LOAD CAPACITY (LBS)	320,000	
EFFICIENCY	28.9%	
MATERIAL	BRONZE	
NOMINAL DIAMETER "A"	6.00 IN.	
NUT LENGTH "B"	6.00 IN.	
THREAD LENGTH "C"	2.000 IN.	
THREAD SIZE	5.497-12 UN	
FLANGE PART NUMBER	FL-5497	
FLANGE DIAMETER "D"	9.75 IN	
FLANGE THICKNESS "E"	2.020 IN.	
FLANGE HOLE DIAMETER "F"	1.031 IN.	
NUMBER OF HOLES IN FLANGE "G"	6	
FLANGE BOLT CIRCLE "H"	8.000 IN.	
FLANGE MATERIAL	BLACK OXIDE COATED STEEL	