

2"-4 SINGLE LEAD ACME

This 2"-4 single lead acme machine screw is available in both alloy steel and stainless steel with a corresponding aluminum bronze nut. Choose from right-hand or left-hand threads.

MACHINE SCREW SPECIFICATIONS	RH	LH
ALLOY STEEL SCREW PART NO.	AS 200 R 025 A	AS 200 L 025 A
STAINLESS STEEL SCREW PART NO.	AS 200 R 025 S	AS 200 L 025 S
THREAD FORM		ACME
SCREW DIAMETER - TURNS / INCH		2" - 4
PITCH / LEAD		0.250 IN.
ROOT DIAMETER		1.695 IN.
SCREW WEIGHT (LBS./ FT.)		9.3
TORQUE TO RAISE 1 POUND		0.162 IN.- LB.
MAXIMUM SCREW LENGTH		12 FEET

Nut and Flange Specifications

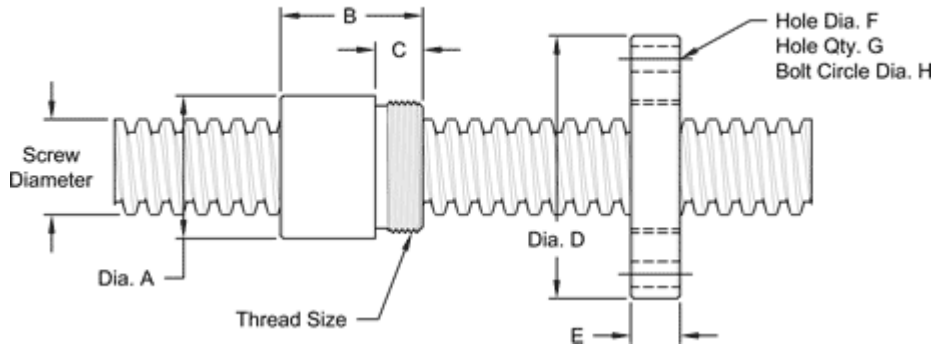

NUT SPECIFICATIONS	RH	LH
NUT PART NO.	AN 200 R 025 B	AN 200 L 025 B
NUT WITH FLANGE PART NO.	AF 200 R 025	AF 200 L 025
DYNAMIC LOAD CAPACITY (LBS.)		20,000
STATIC LOAD CAPACITY (LBS.)		64,000
EFFICIENCY		25.4%
MATERIAL		BRONZE
NOMINAL DIAMETER "A"		2.75 IN.
NUT LENGTH "B"		2.75 IN.
THREAD LENGTH "C"		0.880 IN.
THREAD SIZE		2.548-18 UN
FLANGE PART NO.	FL-2548	
FLANGE DIAMETER "D"		4.94 IN.
FLANGE THICKNESS "E"		0.895 IN.
FLANGE HOLE DIAMETER "F":		0.531 IN
NUMBER OF HOLES IN FLANGE "G"		4
FLANGE BOLT CIRCLE "H"		4.062 IN.
FLANGE MATERIAL		BLACK OXIDE COATED STEEL