

This 2"-4 single lead acme machine screw is available in both alloy steel and stainless steel with a corresponding aluminum bronze nut. Choose from right-hand or left-hand threads.

MACHINE SCREW SPECIFICATIONS	RH	LH
ALLOY STEEL SCREW PART NO.	AS 200 R 025 A	AS 200 L 025 A
STAINLESS STEEL SCREW PART NO.	AS 200 R 025 S	AS 200 L 025 S
THREAD FORM	ACME	
SCREW DIAMETER - TURNS / INCH	2" - 4	
PITCH / LEAD	0.250 IN.	
ROOT DIAMETER	1.695 IN.	
SCREW WEIGHT (LB./ FT.)	9.3	
TORQUE TO RAISE 1 POUND	0.162 IN.- LB.	
MAXIMUM SCREW LENGTH	20 FEET*	

*12 feet for stainless steel stock

Nut and Flange Specifications

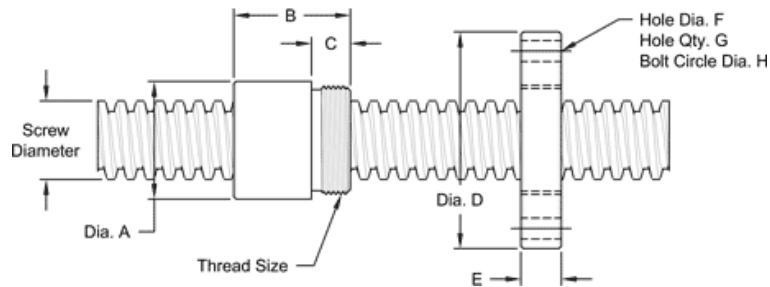

NUT SPECIFICATIONS	RH	LH
NUT PART NO.	AN 200 R 025 B	AN 200 L 025 B
NUT WITH FLANGE PART NO.	AF 200 R 025	AF 200 L 025
DYNAMIC LOAD CAPACITY (LBS.)	20,000	
STATIC LOAD CAPACITY (LBS.)	64,000	
EFFICIENCY	25.4%	
MATERIAL	BRONZE	
NOMINAL DIAMETER "A"	2.75 IN.	
NUT LENGTH "B"	2.75 IN.	
THREAD LENGTH "C"	0.880 IN.	
THREAD SIZE	2.548-18 UN	
FLANGE PART NO.	FL-2548	
FLANGE DIAMETER "D"	4.94 IN.	
FLANGE THICKNESS "E"	0.895 IN.	
FLANGE HOLE DIAMETER "F"	0.531 IN.	
NUMBER OF HOLES IN FLANGE "G"	4	
FLANGE BOLT CIRCLE "H"	4.062 IN.	
FLANGE MATERIAL	BLACK OXIDE COATED STEEL	