

1/2"-2 2/3 SINGLE LEAD ACME

This 1 1/2"-2 2/3 single lead ACME machine screw is available in both alloy steel and stainless steel with a corresponding aluminum bronze nut. Choose from right-hand or left-hand threads.

MACHINE SCREW SPECIFICATIONS	RH	LH
ALLOY STEEL SCREW PART NO.	AS 150 R 038 A	AS 150 L 038 A
STAINLESS STEEL SCREW PART NO.	AS 150 R 038 S	AS 150 L 038 S
THREAD FORM		ACME
SCREW DIAMETER - TURNS / INCH		1 1/2" - 2 2/3
PITCH / LEAD		0.375 IN.
ROOT DIAMETER		1.066 IN.
SCREW WEIGHT (LBS./FT.)		4.6
TORQUE TO RAISE 1 POUND		0.146 IN.-LB.
MAXIMUM SCREW LWNGTH		24 FEET

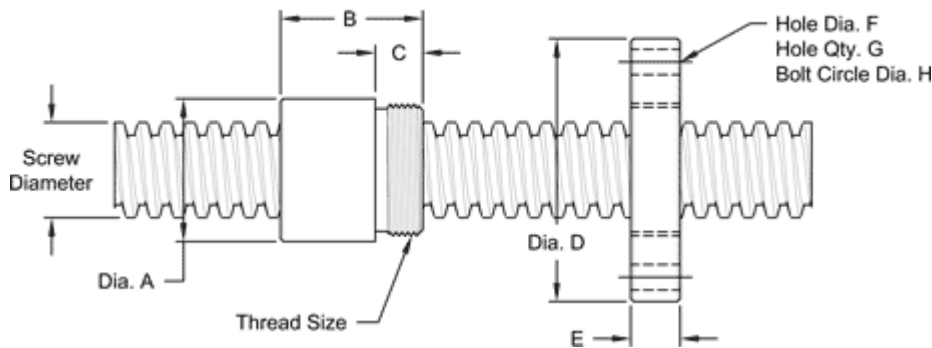

NUT SPECIFICATIONS	RH	LH
NUT PART NO.	AN 150 R 038 B	AN 150 L 038 B
NUT WITH FLANGE PART NO.	AF 150 R 038	AF 150 L 038
DYNAMIC LOAD CAPACITY (LBS.)		11,250
STATIC LOAD CAPACITY (LBS.)		36,000
EFFICIENCY		41.8%
MATERIAL		BRONZE
NOMINAL DIAMETER "A"		2.12 IN.
NUT LENGTH "B"		2.30 IN.
THREAD LENGTH "C"		0.812 IN.
THREAD SIZE		1.967-18 UN
FLANGE PART NO.	FL-1967	
FLANGE DIAMETER "D"		4.20 IN.
FLANGE THICKNESS "E"		0.832 IN.
FLANGE HOLE DIAMETER "F"		0.397 IN.
NUMBER OF HOLES IN FLANGE "G"		4
FLANGE BOLT CIRCLE "H"		3.440 IN.
FLANGE MATERIAL		BLACK OXIDE COATED STEEL