

1 1/4" - 4 SINGLE LEAD ACME

This 1 1/4" – 4 single lead acme machine screw is available in alloy steel and stainless steel with a corresponding aluminum bronze nut. Choose from right-hand or left-hand screw threads.

MACHINE SCREW SPECIFICATIONS	RH	LH
ALLOY STEEL SCREW PART NO.	AS 125 R 025 A	AS 125 L 025 A
STAINLESS STEEL SCREW PART NO.	AS 125 R 025 S	AS 125 L 025 S
THREAD FORM	ACME	
SCREW DIAMETER (TURNS / INCH)	1 1/4" - 4	
PITCH / LEAD	0.250 IN.	
ROOT DIAMETER	0.947 IN.	
SCREW WEIGHT (LBS./FT.)	3.3	
TORQUE TO RAISE 1 POUND	0.113 IN.-LB.	
MAXIMUM SCREW LENGTH	12 FEET	

Nut and Flange Specifications

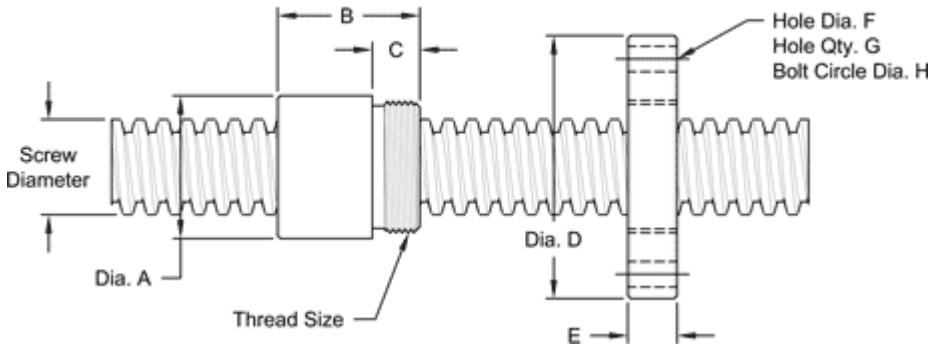

NUT SPECIFICATIONS	RH	LH
NUT PART NO.	AN 125 R 025 B	AN 125 L 025 B
NUT WITH FLANGE PART NO.	AF 125 R 025	AF 125 L 025
DYNAMIC LOAD CAPACITY (LBS.)	7,812	
STATIC LOAD CAPACITY (LBS)	25,000	
EFFICIENCY	36.000%	
MATERIAL	BRONZE	
NOMINAL DIAMETER "A"	2.12 IN.	
NUT LENGTH "B"	1.75 IN.	
THREAD LENGTH "C"	0.812 IN.	
THREAD SIZE	1.967-18 UN	
FLANGE PART NO.	FL-1967	
FLANGE DIAMETER "D"	4.20 IN.	
FLANGE THICKNESS "E"	0.832 IN.	
FLANGE HOLE DIAMETER "F"	0.397 IN.	
NUMBER OF HOLES IN FLANGE "G"	4	
FLANGE BOLT CIRCLE "H"	3.440 IN.	
FLANGE MATERIAL	BLACK OXIDE COATED STEEL	