

PARTS FOR JOYCE BEVEL BALL GEAR SCREW JACKS
 Translating Screw Models No. BB 150, BB 225, and BB 300
 "Upright Style shown for purpose of illustration"

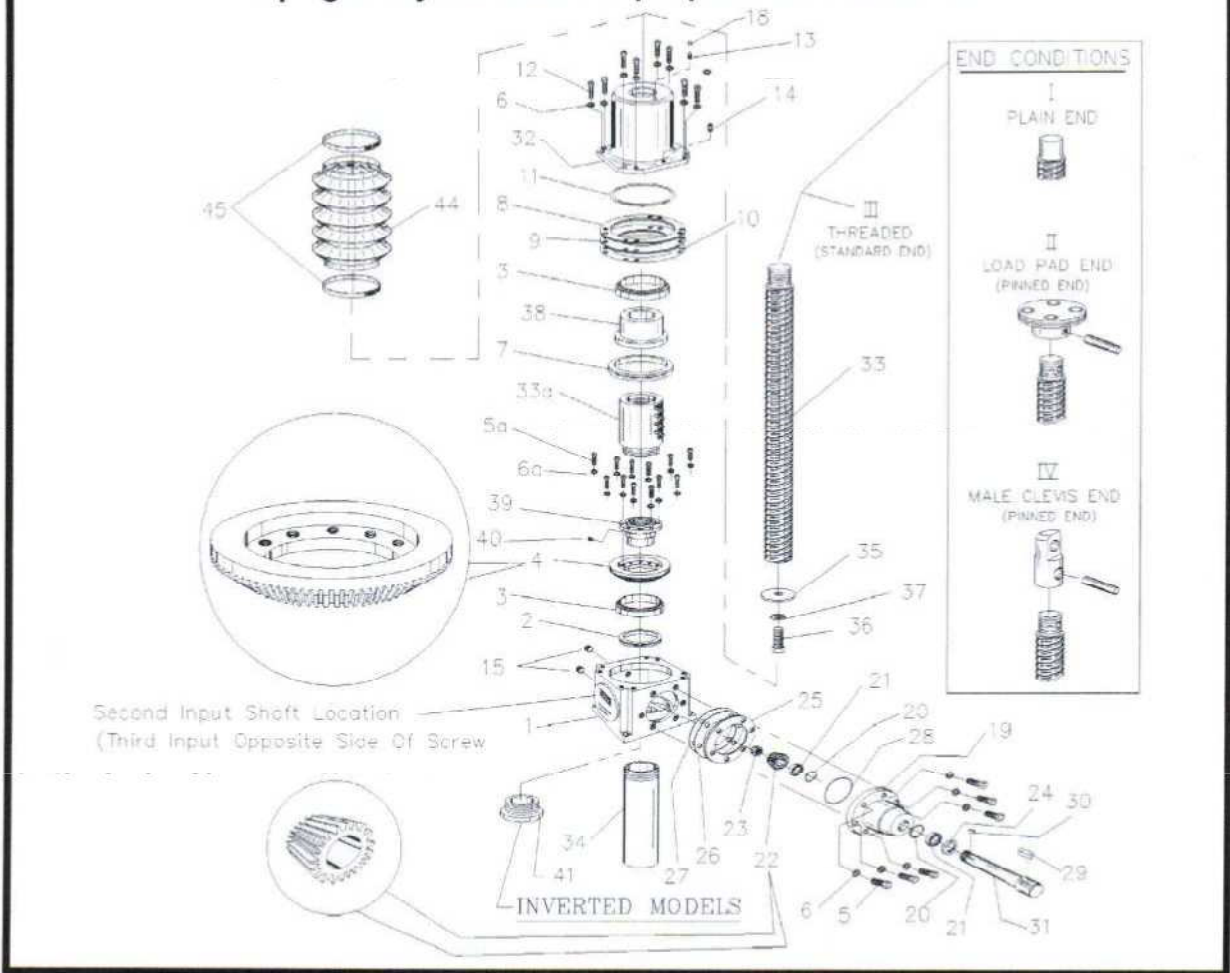

For parts not listed and for custom built jacks, contact Joyce/Dayton Corp.

To order parts give capacity, model and serial number found on the name tag attached to the jack. Also specify whether upright or inverted jack, and end condition of screw.

Below is the name plate as it appears on your jack, mark in the information in the proper spaces exactly as it appears on the jack for your reference.

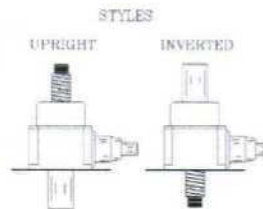

PARTS LIST FOR JOYCE BEVEL BALL GEAR TRANSLATING SCREW JACK

		Model Number								
		BB 150			BB 225			BB 300		
Screw Diameter		1 1/2"			2 1/4"			3"		
Item	Description	Quantity								
1	Sleeve	1			1			1		
2	Seal	1			1			1		
3	Thrust Bearing	2			2			2		
4	Gear	1			1			1		
Note: Item 5 & 6 and Item 19-31 below quantities are shown according to number of input shafts										
Number Of Shaft Inputs		1	2	3	1	2	3	1	2	3
5	Screw, Carrier Mtg.	4	8	12	6	12	18	6	12	18
6	Lockwasher, Carrier Mtg.	4	8	12	6	12	18	6	12	18
5a	Screw, Bevel Gear Mtg	6			6			6		
6a	Lockwasher, Bevel Gear Mtg. And Sleeve Cap	14			14			14		
7	Upper Seal	1			1			1		
8	Shim, Blue	3			3			3		
9	Shim, Clear	3			3			3		
10	Shim, Yellow	1			1			1		
11	"O" Ring, Large	1			1			1		
12	Sleeve Cap Screw	8			8			8		
13	Grease Fitting	1			1			1		
14	Fill Vent	1			1			1		
15	Pipe Plug	2			2			2		
16	Name Plate	1			1			1		
17	Name Plate Screw	2			2			4		
18	Grease Fitting Cap	1			1			1		
Number Of Shaft Inputs		1	2	3	1	2	3	1	2	3
19	Carrier Housing	1	2	3	1	2	3	1	2	3
20	Retaining Ring	2	4	6	2	4	6	2	4	6
21	Bearing	2	4	6	2	4	6	2	4	6
22	Bevel Pinion	1	2	3	1	2	3	1	2	3
23*	Locknut	1	2	3	1	2	3	1	2	3
24	Seal	1	2	3	1	2	3	1	2	3
25	Carrier Shim, Blue	6	12	24	6	12	24	5	12	24
26	Carrier Shim, Clear	6	12	24	6	12	24	6	12	24
27	Carrier Shim, Yellow	2	4	6	2	4	6	2	4	6
28	"O" Ring	1	2	3	1	2	3	1	2	3
29	Key, Shaft	1	2	3	1	2	3	1	2	3
30**	Woodruff Key	1	2	3	1	2	3	1	2	3
31	Input Shaft	1	2	3	1	2	3	1	2	3
32	Sleeve Cap	1			1			1		
33	Ball Screw Assembly (Includes Screw End Condition)	1			1			1		
33a	Bull Nut Assembly	1			1			1		
34	Protection Tube Assembly	1			1			1		
35	Screw Stop	1			1			1		
36	Screw Stop Screw	1			1			1		
37	Screw Stop Lockwasher	1			1			1		
38	Top Bearing Adapter	1			1			1		
39	Ball Nut Adapter	1			1			1		
40	Set Screw, Ball Screw Thd.	1			1			1		
41	Inverted Bushing	1			1			1		
44	Boot, Translating Screw Protection	1			1			1		
45	Boot Clamps	2			2			2		

* - Locknut Is On Opposite End Of The Input Shaft On The BB 225 And BB250 Jacks.
 ** - Not Used On BB 150.

HOW TO ORDER REPLACEMENT PARTS

In ordering spare parts list the model number of the Jack and the item number required. The serial number is the only means to positively identify your Jack.

The quantities listed under the various models number indicate the quantity required for a complete jack.

PARTS FOR JOYCE BEVEL BALL GEAR SCREW JACKS

Keyed For Traveling Nut Screw Models No. BB 150, BB 225, and BB 300
 "Upright Style shown for purpose of illustration"

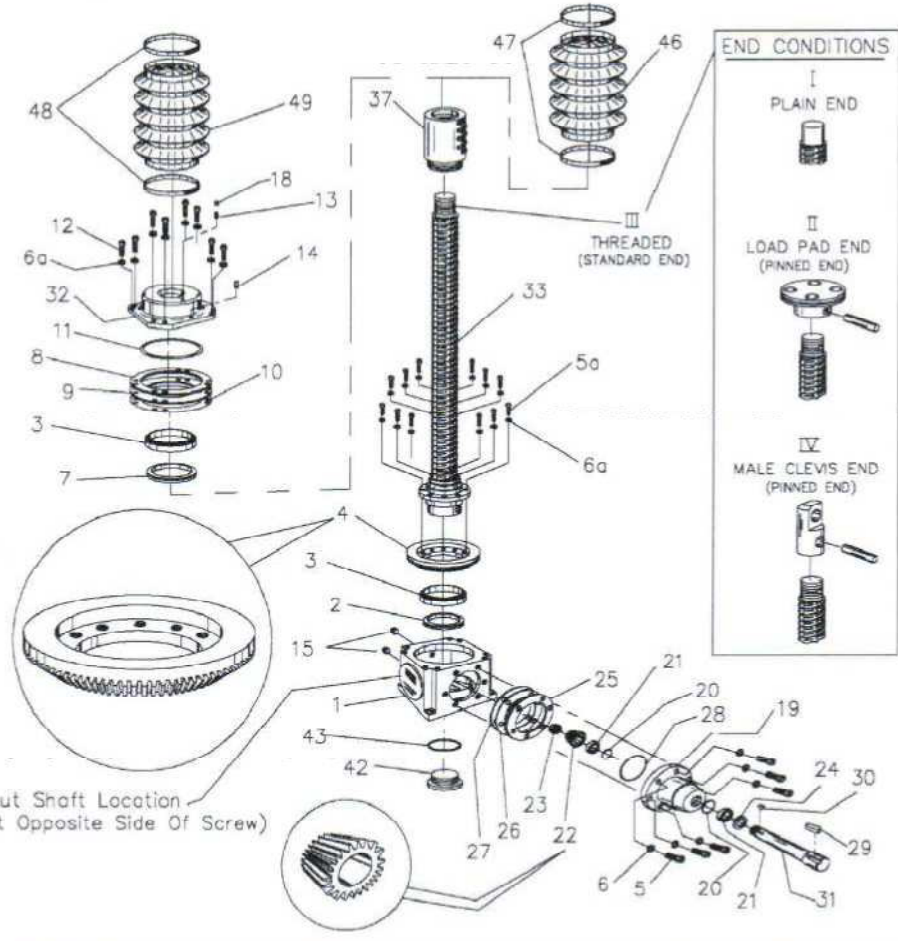

For parts not listed and for custom built jacks, contact Joyce/Dayton Corp.

To order parts give capacity, model and serial number found on the name tag attached to the jack. Also specify whether upright or inverted jack, and end condition of screw.

Below is the name plate as it appears on your jack, mark in the information in the proper spaces exactly as it appears on the jack for your reference.

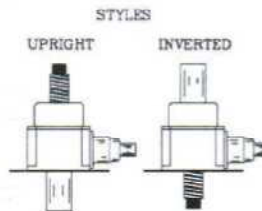

PARTS LIST FOR JOYCE BEVEL BALL GEAR JACK KEYED FOR TRAVELING NUT JACK

Screw Diameter		Model Number								
		BB 150			BB 225			BB 300		
		1 1/2"			2 1/4"			3"		
Item	Description	Quantity								
1	Sleeve	1			1			1		
2	Seal	1			1			1		
3	Thrust Bearing	2			2			2		
4	Gear	1			1			1		
Note: Item 5 & 6 and Item 19-31 below quantities are shown according to number of input shafts										
Number Of Shaft Inputs		1	2	3	1	2	3	1	2	3
5	Sleeve, Carrier Mtg.	4	8	12	6	12	18	6	12	18
6	Lockwasher	4	8	12	6	12	18	6	12	18
5a	Screw, Bevel Gear Mtg.	6			6			6		
6a	Lockwasher, Bevel Gear Mtg. and Sleeve Cap	14			14			14		
7	Upper Seal	1			1			1		
8	Shim, Blue	3			3			3		
9	Shim, Clear	3			3			3		
10	Shim, Yellow	1			1			1		
11	"O" Ring, Large	1			1			1		
12	Sleeve Cap Screw	8			8			8		
13	Grease Fitting	1			1			1		
14	Fill Vent	1			1			1		
15	Pipe Plug	2			2			2		
16	Name Plate	1			1			1		
17	Name Plate Screw	2			2			4		
18	Grease Fitting Cap	1			1			1		
Number Of Shaft Inputs		1	2	3	1	2	3	1	2	3
19	Carrier Housing	1	2	3	1	2	3	1	2	3
20	Retaining Ring	2	4	6	2	4	6	2	4	6
21	Bearing	2	4	6	2	4	6	2	4	6
22	Bevel Pinion	1	2	3	1	2	3	1	2	3
23*	Locknut	1	2	3	1	2	3	1	2	3
24	Seal	1	2	3	1	2	3	1	2	3
25	Carrier Shim, Blue	6	12	24	6	12	24	5	12	24
26	Carrier Shim, Clear	6	12	24	6	12	24	6	12	24
27	Carrier Shim, Yellow	2	4	6	2	4	6	2	4	6
28	"O" Ring	1	2	3	1	2	3	1	2	3
29	Key, Shaft	1	2	3	1	2	3	1	2	3
30**	Woodruff Key	1	2	3	1	2	3	1	2	3
31	Input Shaft	1	2	3	1	2	3	1	2	3
OIL AMOUNT IN OUNCES		18	20	22	45	48	51	100	104	108
32	Sleeve Cap	1			1			1		
33	Ball Screw Assembly (Includes End Condition)	1			1			1		
37	Ball Nut Assembly	1			1			1		
38	Top Bearing Adapter	1			1			1		
39	Ball Nut Adapter	1			1			1		
40	Set Screw, Ball Screw Thd.	1			1			1		
42	Plug, Sleeve Bottom	1			1			1		
43	"O" Ring, Bottom Plug	1			1			1		
46	Top Boot, Keyed For Traveling Nut Screw Protection	1			1			1		
47	Top Boot Clamps	2			2			2		
48	Bottom Boot, Keyed For Travelling Nut Screw Protection	1			1			1		
49	Bottom Boot Clamps	2			2			2		

* - Locknut is On Opposite End Of The Input Shaft On The BB225 And BB250 Jacks.
 ** - Not Used On BB150.

HOW TO ORDER REPLACEMENT PARTS

In ordering spare parts list the model number of the Jack and the item number required. The serial number is the only means to positively identify your Jack.

The quantities listed under the various models number indicate the quantity required for a complete jack.