

SELECTION GUIDE WORKSHEET BELLOWS AND COVERS

Name _____ Title _____
Company _____ Project _____
Address _____
Phone _____ Fax _____ Email _____

Standard bellows are available for Joyce/Dayton Jacks and Actuators. If you need additional information contact Joyce/Dayton.

Bellows Shape

- Round
- Square/Rectangle
- Curtain
- C-Shape
- U-Shape

Bellows Will Be Used To Protect:

- Machine Screw
- Ball Screw
- Guide Rods
- Slides or Ways
- Hydraulic Cylinder Rod
- Pneumatic Cylinder Rod
- Other

Bellows Attachment First End

Mounting Shape

- Round
- Square/Rectangle
- Curtain
- Other

Mounting Style

- Collar
- Flange

Collar Details

- _____ Diameter
- _____ Length

Flange Details

- _____ I.D. Dimension
- _____ O.D. Dimension
- _____ Bolt Circle
- _____ Flange Plate

Bellows Attachment Second End

Mounting Shape

- Round
- Square/Rectangle
- Curtain
- Other

Mounting Style

- Collar
- Flange

Collar Details

- _____ Diameter
- _____ Length

Flange Details

- _____ I.D. Dimension
- _____ O.D. Dimension
- _____ Bolt Circle
- _____ Flange Plate

Diameter To Be Covered

- _____ inch
- _____ mm

Mounting Orientation

- Vertical
- Horizontal

Extended Dimension

- _____ inch
- _____ mm

Retracted Dimension

- _____ inch
- _____ mm

Environmental and Other Considerations

Temperature

- + _____ °F to - _____ °F
- + _____ °C to - _____ °C

Environment

- Dust
- Sand
- Oil
- Wash Down
- Dirt
- Water
- Outdoor

Application Factors

- Vegetable or Animal Oils, Weather, Abrasion
- Ozone, Acids, Vegetable or Animal Oils, Abrasion
- Weather, Mildew
- Weld Splatter, Flame
- Most Chemicals

Other Options

- Tabs to stabilize long vertical bellows
- Zippered bellows for replacement or when access to machinery is limited
- Internal guides for long horizontal bellows
- Grommets for vertical or horizontal guide wires

Design Tips

Please include a drawing along with your worksheet submission.

1. Design and order equipment with the bellows in mind to maximize extended travel and minimize retracted distances.
2. Allow room for the retracted bellows in your overall design. Adding bellows increases the space required.
3. Zippered bellows will increase closed dimensions, but they make bellows replacement/installation possible when machines cannot be disassembled.

SELECTION GUIDE WORKSHEET BELLOWS AND COVERS

Select the style of bellows or cover needed and add dimensions to the corresponding chart. The diagrams below depict the common configurations but other options are available. To order C-shaped, curtain, or platform skirt bellows, contact Joyce/Dayton or visit us online. Custom bellows are also available.

Round Bellows

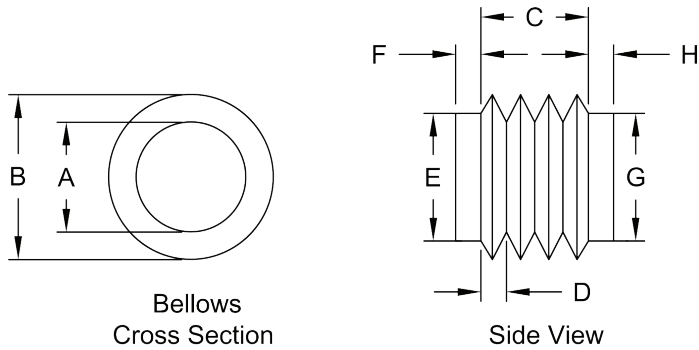

Round Bellows (Sewn Construction)				
(A)		Bellows I.D.	(E)	Collar ID
(B)		Bellows O.D.	(F)	Collar Length
(C)		Extended Length	(G)	Collar ID
(D)		Retracted Length	(H)	Collar Length

U-Shaped Way Covers

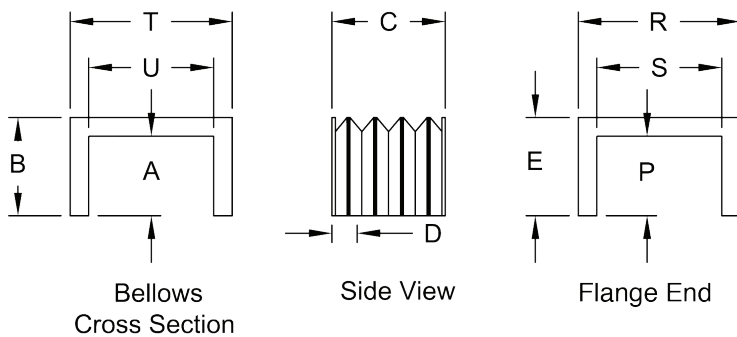

U-Shaped Way Cover (Sewn Construction)				
(A)		Bellows Inside Height	(P)	Flange Inside Height
(B)		Bellows Outside Height	(R)	Flange Outside Width
(C)		Extended Length	(S)	Flange Inside Width
(D)		Retracted Length	(T)	Bellows Outside Width
(E)		Flange Outside Height	(U)	Bellows Inside Width

Square or Rectangular Bellows

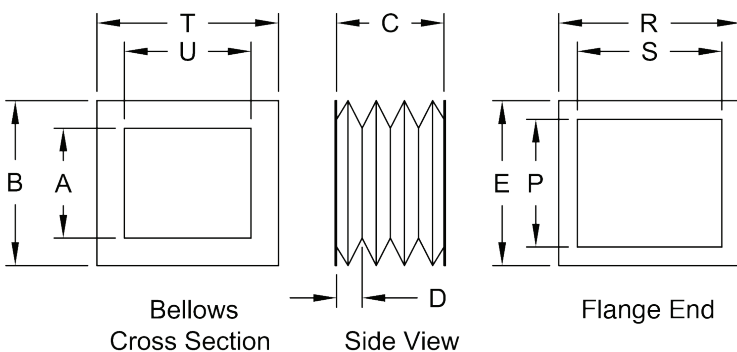

Square or Rectangular Bellows (Sewn Construction)				
(A)		Bellows Inside Height	(P)	Flange Inside Height
(B)		Bellows Outside Height	(R)	Flange Outside Width
(C)		Extended Length	(S)	Flange Inside Width
(D)		Retracted Length	(T)	Bellows Outside Width
(E)		Flange Outside Height	(U)	Bellows Inside Width