

# 5/8 - 8 STUB ACME MACHINE SCREW

Available in stainless steel with a corresponding aluminum bronze nut.  
Choose from RH threads or LH threads.

MACHINE SCREW SPECIFICATIONS	RH	LH
STAINLESS STEEL SCREW PART NO.	SS 063 R 013 S	SS 063 L 013 S
THREAD FORM	STUB ACME	
SCREW DIAMETER - TURNS / INCH	5/8 - 8	
PITCH / LEAD	0.125 IN.	
ROOT DIAMETER	0.507 IN.	
SCREW WEIGHT (LB. /FT.)	0.85	
TORQUE TO RAISE 1 POUND	0.058 IN.LB.	
MAXIMUM SCREW LENGTH	12 FEET	

## NUT AND FLANGE SPECIFICATIONS

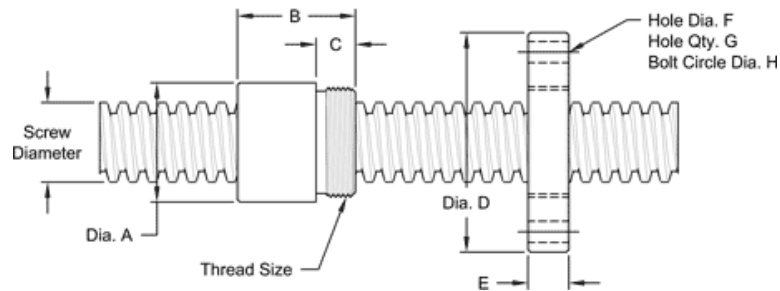

NUT SPECIFICATIONS	RH	LH
NUT PART NO.	SN 063 R 013 B	SN 063 L 013 B
FLANGED NUT PART NO	SF 063 R 013	SF 063 L 013
DYNAMIC LOAD CAPACITY (LBS)	1,953	
STATIC LOAD CAPACITY (LBS)	6,250	
EFFICIENCY	35.0 %	
MATERIAL	BRONZE	
NOMINAL DIAMETER "A"	1.12 IN.	
NUT LENGTH "B"	1.00 IN.	
THREAD LENGTH "C"	0.50 IN.	
THREAD SIZE	0.93716 UN	
FLANGE PART NO.	FL0937	
FLANGE DIAMETER "D"	2.60 IN.	
FLANGE THICKNESS "E"	0.53 IN.	
FLANGE HOLE DIAMETER "F"	0.266 IN.	
NUMBER OF HOLES IN FLANGE "G"	4	
FLANGE BOLT CIRCLE "H"	2.090 IN.	
FLANGE MATERIAL	BLACK OXIDE COATED STEEL	