

# 4 1/2" - 1 1/2 SINGLE LEAD ACME MACHINE SCREW

Available in both alloy steel and stainless steel with a corresponding aluminum bronze nut.  
Right hand and left hand threads are available.

MACHINE SCREW SPECIFICATIONS	RH	LH
ALLOY STEEL SCREW PART NO.	AS 450 R 067 A	AS 450 L 067 A
STAINLESS STEEL SCREW PART NO.	AS 450 R 067 S	AS 450 L 067 S
THREAD FORM	ACME	
SCREW DIAMETER - TURNS/INCH	4 1/2" - 1 1/2	
PITCH/LEAD	0.067 IN.	
ROOT DIAMETER	3.757 IN.	
SCREW WEIGHT (LB/FT)	45.0	
TORQUE TO RAISE 1 POUND	0.378 IN.LB.	
MAXIMUM SCREW LENGTH	20 FEET*	

\* 12 feet for stainless steel stock

## NUT AND FLANGE SPECIFICATIONS

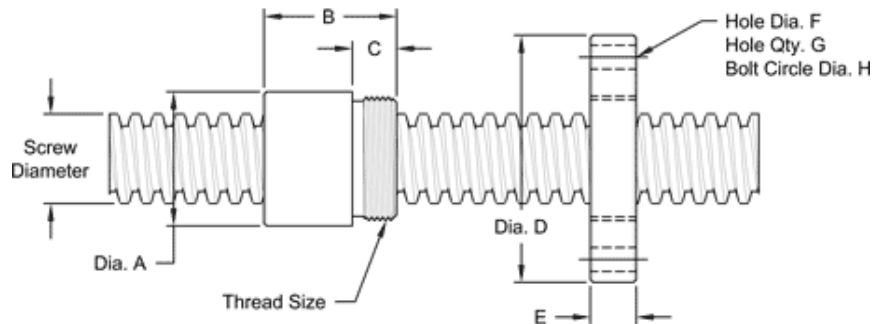

NUT SPECIFICATIONS	RH	LH
NUT PART NO.	AN 450 R 067 B	AN 450 L 067 B
NUT WITH FLANGE PART NO.	AF 450 R 067	AF 450 L 067
DYNAMIC LOAD CAPACITY (LBS)	100,000	
STATIC LOAD CAPACITY (LBS).	..320,000	
EFFICIENCY	28.9%	
MATERIAL	BRONZE	
NOMINAL DIAMETER "A"	6.00 IN.	
NUT LENGTH "B"	6.00 IN.	
THREAD LENGTH "C"	2.000 IN.	
THREAD SIZE	5.49712 UN	
FLANGE PART NUMBER	FL5497	
FLANGE DIAMETER "D"	9.75 IN.	
FLANGE THICKNESS "E"	2.020 IN.	
FLANGE HOLE DIAMETER "F"	1.031 IN.	
NUMBER OF HOLES IN FLANGE "G"	6	
FLANGE BOLT CIRCLE "H"	8.000 IN.	
FLANGE MATERIAL	BLACK OXIDE COATED STEEL	