

3 3/8"-1 1/2 SINGLE LEAD STUB ACME MACHINE SCREW

Available in both alloy steel and stainless steel with a corresponding aluminum bronze nut.
Right hand and left hand threads are available.

MACHINE SCREW SPECIFICATIONS	RH	LH
ALLOY STEEL SCREW PART NO.	SS 338 R 067 A	SS 338 L 067 A
STAINLESS STEEL SCREW PART NO.	SS 338 R 067 S	SS 338 L 067 S
THREAD FORM	STUB ACME	
SCREW DIAMETER - TURNS/INCH	3 3/8" 1 1/2	
PITCH/LEAD	0.667 IN.	
ROOT DIAMETER	2.902 IN.	
SCREW WEIGHT (LB./FT.)	20.1	
TORQUE TO RAISE 1 POUND	0.314 IN.LB.	
MAXIMUM SCREW LENGTH	20 FEET*	

* 12 feet for stainless steel stock

NUT AND FLANGE SPECIFICATIONS

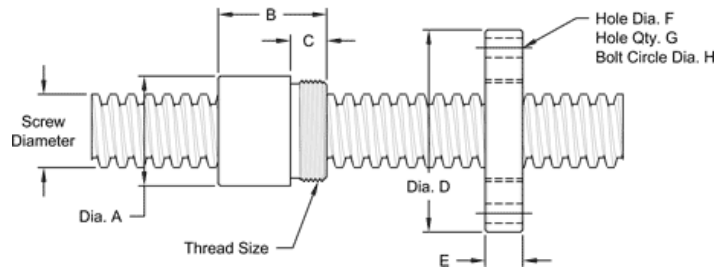

NUT SPECIFICATIONS	RH	LH
NUT PART NUMBER	SN 338 R 067 B	SN 338 L 067 B
NUT WITH FLANGE	SF 338 R 067	SF 338 L 067
DYNAMIC LOAD CAPACITY (LBS.)	40,000	
STATIC LOAD CAPACITY (LBS.)	100,000	
EFFICIENCY	34.7%	
MATERIAL	BRONZE	
NOMINAL DIAMETER "A"	4.50 IN.	
NUT LENGTH "B"	4.50 IN.	
THREAD LENGTH "C"	2.00 IN.	
THREAD SIZE	4.32512 UN	
FLANGE PART NUMBER	FL4325	
FLANGE DIAMETER "D"	7.38 IN	
FLANGE THICKNESS "E"	2.020 IN.	
FLANGE HOLE DIAMETER "F"	0.781 IN.	
NUMBER OF HOLES IN FLANGE "G"	6	
FLANGE BOLT CIRCLE "H"	6.250 IN.	
FLANGE MATERIAL	BLACK OXIDE COATED STEEL	