

# 2 1/4" - 2 SINGLE LEAD ACME MACHINE SCREW

Available in both alloy steel and stainless steel with a corresponding aluminum bronze nut.  
Right hand and left hand threads are available.

MACHINE SCREW SPECIFICATIONS	RH	LH
ALLOY STEEL SCREW PART NO.	AS 225 R 050 A	AS 225 L 050 A
STAINLESS STEEL SCREW PART NO.	AS 225 R 050 S	AS 225 L 050 S
THREAD FORM	ACME	
SCREW DIAMETER - TPI	2 1/4" - 2	
PITCH/LEAD	0.500 IN.	
ROOT DIAMETER	1.685 IN.	
SCREW WEIGHT (LB./FT.)	10.6	
TORQUE TO RAISE 1 POUND	.211 IN.LB.	
MAXIMUM SCREW LENGTH	20 FEET *	

\* 12 feet for stainless steel stock

## NUT AND FLANGE SPECIFICATIONS

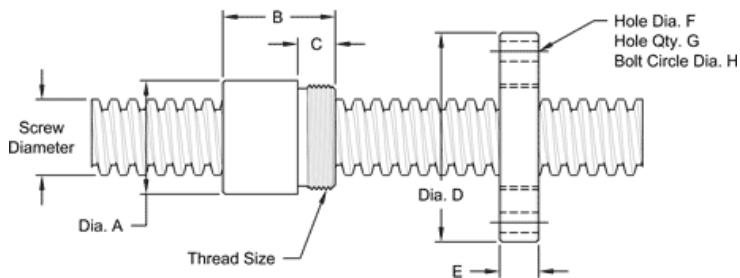

NUT SPECIFICATIONS	RH	LH
NUT PART NUMBER	AN 225 R 050 B	AN 225 L 050 B
NUT WITH FLANGE	AF 225 R 050	AF 225 L 050
DYNAMIC LOAD CAPACITY (LBS.)	30,000	
STATIC LOAD CAPACITY (LBS.)	81,000	
EFFICIENCY	38.7%	
MATERIAL	BRONZE	
NOMINAL DIAMETER "A"	3.38 IN.	
NUT LENGTH "B"	3.06 IN.	
THREAD LENGTH "C"	1.560 IN.	
THREAD SIZE	3.13712 UN	
FLANGE PART NUMBER	FL3137	
FLANGE DIAMETER "D"	5.38 IN.	
FLANGE THICKNESS "E"	1.580 IN.	
FLANGE HOLE DIAMETER "F"	0.656 IN.	
NUMBER OF HOLES IN FLANGE "G"	6	
FLANGE BOLT CIRCLE "H"	4.375 IN.	
FLANGE MATERIAL	BLACK OXIDE COATED STEEL	