

1 1/2" - 4 SINGLE LEAD ACME MACHINE SCREW

Available in both alloy steel and stainless steel with a corresponding aluminum bronze nut.
Right hand and left hand threads are available.

MACHINE SCREW SPECIFICATIONS	RH	LH
ALLOY STEEL SCREW PART NO.	AS 150 R 025 A	AS 150 L 025 A
STAINLESS STEEL SCREW PART NO.	AS 150 R 025 S	AS 150 L 025 S
THREAD FORM	ACME	
SCREW DIAMETER (TURNS / INCH)	1 1/2" - 4	
PITCH / LEAD	0.250 IN.	
ROOT DIAMETER	1.196 IN.	
SCREW WEIGHT (LB./FT.)	5.0	
TORQUE TO RAISE 1 POUND	0.130 IN.LB.	
MAXIMUM SCREW LENG TH	20 FEET*	

* 12 feet for stainless steel stock

NUT AND FLANGE SPECIFICATIONS

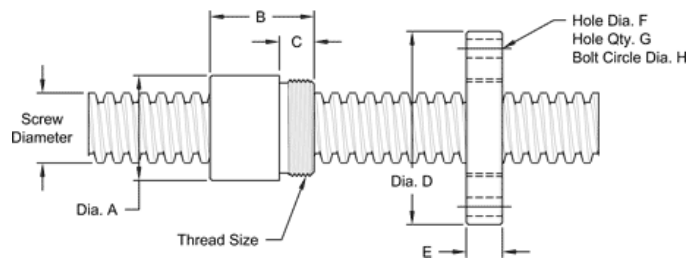

NUT SPECIFICATIONS	RH	LH
NUT PART NO.	AN 150 R 025 B	AN 150 L 025 B
NUT WITH FLANGE PART NO.	AF 150 R 025	AF 150 L 025
DYNAMIC LOAD CAPACITY (LBS.)	11,250	
STATIC LOAD CAPACITY (LBS.)	36,000	
EFFICIENCY	31.6%	
MATERIAL	BRONZE	
NOMINAL DIAMETER "A"	2.12 IN.	
NUT LENGTH "B"	2.30 IN.	
THREAD LENGTH "C"	0.812 IN.	
THREAD SIZE	1.96718 UN	
FLANGE PART NO.	FL1967	
FLANGE DIAMETER "D"	4.20 IN.	
FLANGE THICKNESS "E"	0.832 IN.	
FLANGE HOLE DIAMETER "F"	0.397 IN.	
NUMBER OF HOLES IN FLANGE "G"	4	
FLANGE BOLT CIRCLE "H"	3.440 IN.	
FLANGE MATERIAL	BLACK OXIDE COATED STEEL	