

1" - 1 MULTIPLE LEAD ACME MACHINE SCREW

Available in alloy steel with a corresponding aluminum bronze nut.
Right hand threads are available.

MACHINE SCREW SPECIFICATIONS	RH
ALLOY STEEL SCREW PART NO.	SS 100 R 100 A
THREAD FORM	STUB ACME
SCREW DIAMETER (TURNS/INCH)	1 1
PITCH / LEAD	0.010IN./1.00 IN.
ROOT DIAMETER	.930 IN.
SCREW WEIGHT (LB./FT.)	2.4
TORQUE TO RAISE 1 POUND	0.233 IN.- LB.
MAXIMUM SCREW LENGTH	12 FEET

NUT AND FLANGE SPECIFICATIONS

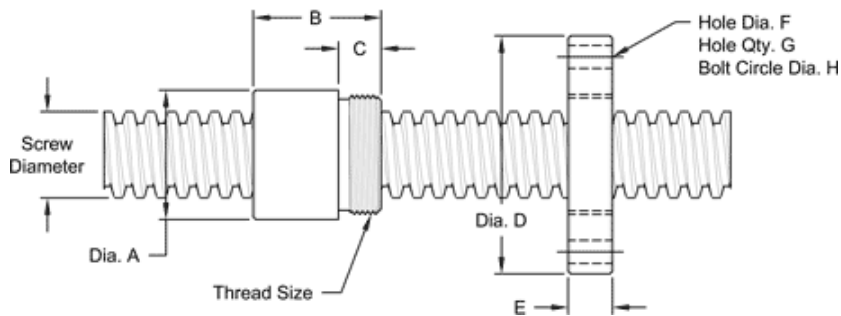

NUT SPECIFICATIONS	RH
NUT PART NO.	SN 100 R 100 B
NUT WITH FLANGE PART NO.	SN 100 R 100
DYNAMIC LOAD CAPACITY (LBS.)	5,000
STATIC LOAD CAPACITY (LBS.)	16,000
EFFICIENCY	69.70%
MATERIAL	BRONZE
NOMINAL DIAMETER "A"	1.50 IN.
NUT LENGTH "B"	1.50 IN.
THREAD LENGTH "C"	0.50 IN.
THREAD SIZE	1.37516 UN
FLANGE PART NUMBER	FL1375
FLANGE DIAMETER "D"	2.75 IN.
FLANGE THICKNESS "E"	0.52 IN.
FLANGE HOLE DIAMETER "F"	0.266 IN.
NUMBER OF HOLES IN FLANGE "G"	4
FLANGE BOLT CIRCLE "H"	2.260 IN.
FLANGE MATERIAL	BLACK OXIDE COATED STEEL